



# Spring 2003 Update

## Long Winter Encourages Progress in the Lab

The winter has been long and cold, but spring has finally arrived and we can't wait to get back into the field. However, the weather was persuasive enough to keep us inside to work on the backlog of laboratory activities. Volunteers continued pouring in to the Rosewell Visitor Center on lab nights to wash and label thousands of artifacts, and crossmend cups, dishes, and a lamp chimney found within the house. Everything excavated from within the house foundations is now cataloged and the few remaining materials from the formal garden are being processed as we speak.

on our excavations around the manor house. This will be the first official report on the archaeology of Fairfield and we expect many more in the future.

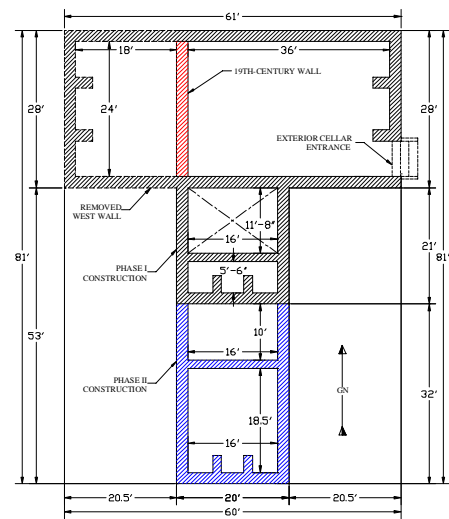

Foundation Plan of Fairfield

### Inside this issue:

- Historic Highway Marker Approved 2
- Fairfield Hosts Firelands Field School in May 2
- MAAC Participants Visit Fairfield 2
- Fairfield's New Website: 3
- Artifact of the Month: Wine Bottle Seals 3
- Welcome to New Members 4

### Fairfield Facts:

- At its height in the 18th century, Fairfield was over 7000 acres
- Lewis Burwell I (1710-1756) was President of the Governor's Council and acting Governor of Virginia for 6 Months in 1751
- Fairfield burned in 1897.

All of this lab work will contribute towards an upcoming report

## Student Projects Continue

This school year we have five students from Gloucester and York High School working with us on research projects ranging from elevation drawings of the house to analyzing the historic photographs of Fairfield. Several of the students are returning from last year. Collin Riley is expanding Lauren Bauer's study of the 19th-century bottles recovered from within the cellar and Mike Pierce is analyzing the late 19th-century material culture seen in the six photographs of

Fairfield. Another returning student, Nathan Miller, is designing interpretive signs to be used on the site. Newcomer Erin Harris is charting the Burwells' occupation of Fairfield to help assess changes in the number of family members living at the plantation during the 17th and 18th centuries. Finally, Ashton Lee, of York County, is drawing elevations of the west and south facades of Fairfield, completing the work begun by Jaime Cascante last year.

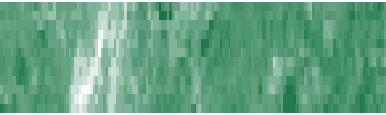

### Highway marker text:

**Two miles west stood Fairfield, also called Carter's Creek plantation, one of the most distinguished of Virginia's early brick homes. Built about 1694 for Lewis Burwell (c. 1651-1710), the house was a grand T-shaped structure, with distinctive double and triple diagonally set chimney stacks joined at the caps, two separate vaulted cellars, and a large ballroom. The plantation also included a large formal garden, slave quarters, and other buildings necessary to operate a large plantation. The influential Burwell family lived here until about 1787, the house was destroyed by fire about 1897. The Fairfield site was listed in 1973 on the Virginia Landmarks Register and the National Register of Historic Places.**



## Historic Highway Marker Approved

The Fairfield marker was approved at the recent meeting of the review board for the State Historic Highway Marker program. A draft of the sign's text was submitted in December and the staff of the Department of Historic Resources helped guide it through the review process. A location for the sign was chosen along Rt. 17,

and we hope to have the sign in place later this summer.

This marker was made possible through the generosity of many individuals, and we thank you for contributing to this fund. Your gifts will help raise awareness of Gloucester's important history and spread the word about our research at Fairfield plantation.

## Fairfield Hosts Firelands Field School in May

Fairfield will be hosting a field school from Firelands College in Ohio, between the 19th and 23rd of May. The class is expected to have a dozen students plus their professor, Jennifer Williams. All aspects of Historical Archaeology will be presented to the students during their stay at Fairfield. Their time will be divided between excavating on site and lab work.

The field school has been a long time coming. Starting in the fall of 2001 when Ms. Williams visited the foundation's web site, to a site visit in the spring of 2002, the planning stage is finally over and everyone is ready to start digging. We are all looking forward to this experience, and it should be a productive and educational week.

## MAAC Participants Visit Fairfield

The Fairfield Foundation was privileged to be part of this year's Mid-Atlantic Archeology Conference (MAAC) pre-conference field trip which also included Rosewell, Weromocomoco, and the archaeology lab at Colonial Williamsburg. Over 30 conference participants visited Fairfield on the 13th of March. The group included

professional and amateur archaeologists from Virginia, New York, and throughout the east coast. The visit offered a unique opportunity to "show-off" the site and to introduce our research at Fairfield to a new audience. Everyone benefited from the exchange of ideas and information and we welcome all of the conference goers back again soon.

## Fairfield's New Website: [www.fairfieldfoundation.org](http://www.fairfieldfoundation.org)

A recent grant from the Virginia Foundation for the Humanities (VFH) is supporting the design of a new website that will contain the three-dimensional digital Fairfield that Gloucester High School senior Nathan Miller is developing. The initial stages of the website are under construction and more information is being added everyday. All of the email updates, numerous photographs of the site and artifacts, contact information, and other materials will be available on the website.

The virtual Fairfield project, made possible through the generous support of the VFH and individual



donors, will allow visitors to better understand the evolution of Fairfield and its surrounding landscape over three centuries of occupation. This is an exciting project, and both Mr. Miller and Kay Helm, our website designer, are working hard to produce a useful and educational program to enable everyone to learn more about Gloucester's past.

### Volunteers At Fairfield

- During 2002 volunteers logged more than 625 hours helping the Fairfield Foundation
- Dozens of 4th and 5th grade students from Petsworth and T.C. Walker Elementary Schools participated in educational programs
- To date Volunteers have helped the Fairfield archaeologists find over 100,000 artifacts and dig over 5,000 cubic feet of soil at the site.

## Artifact of the Month: Wine Bottle Seals



### **Wine Bottle Seals Found at Fairfield**

**Left to right: Lewis Burwell II, Nathaniel Burwell (1715), Robert Carter**

Archaeologists and volunteers at Fairfield have recovered nearly 40 late 17th-/early 18th-century wine bottle seals. Many of these seals were found in or above the clay borrow pit, while others were found in the house cellar. The majority of the seals bear the initials of Lewis Burwell II,

builder of Fairfield, Nathaniel, his eldest son, and Robert Carter, the wealthiest man in Virginia. We do have a handful of mystery seals that have not been identified and look forward to discovering more about the people behind these significant artifacts.

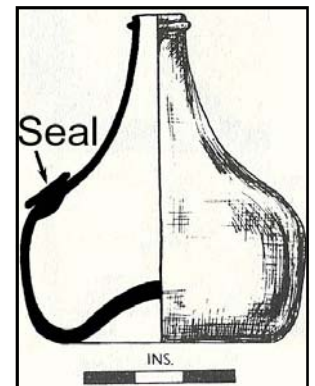

**FAIRFIELD  
FOUNDATION, INC.**

P.O. Box 157  
White Marsh VA 23183  
Phone: 804-694-4775  
Email: fairfield@ccsinc.com



**1847 Sketch of Fairfield**

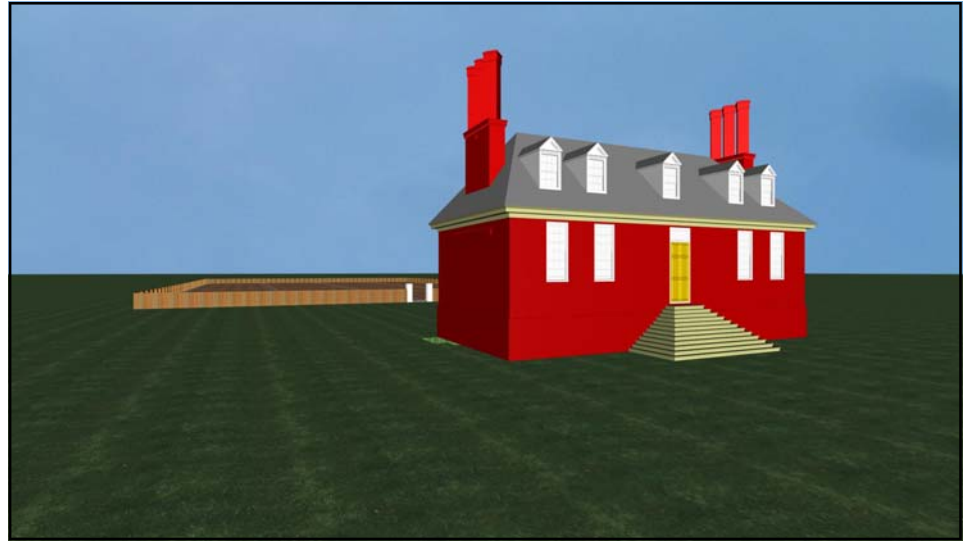

**Preliminary 3-D Reconstruction of Fairfield**

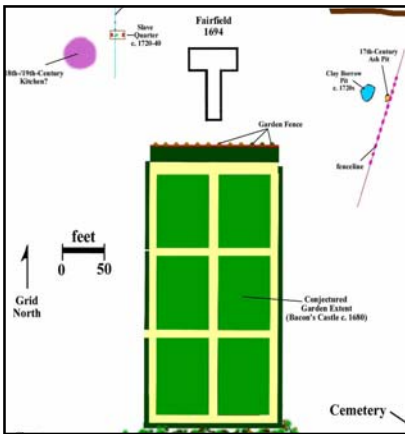
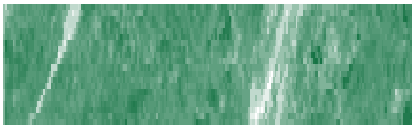

**Possible Reconstruction of the Gardens at Fairfield.**



The Fairfield Foundation is a 501(c)3 not-for-profit organization dedicated to the archaeological study of the Burwell plantation in Gloucester County, known as Fairfield/Carter's Creek. The foundation has launched an extended investigation into all aspects of this colonial plantation, with the goal of studying, preserving, and presenting this new knowledge to the public.

Check Us Out On The Web at  
[www.fairfieldfoundation.org](http://www.fairfieldfoundation.org)

**Welcome to New Members**

December marked the launching of our Membership drive. We are pleased to recognize and welcome the following new members for 2003:

**Basic**

- Sherwood H. Bowditch
- Linda Bryson
- Robert & Jennie Howe
- P. Hairston Seawell

**Family**

- George & Kay Lewis
- Louise Nemecek

**Friends**

- Gene Hardin
- Rod and Karen Lorence
- Jennifer & Derek Williams

**Carter Creek Society**

- Janet & Tim Brown
- Herman Burwell
- Warren Chauncey
- Will R. Gregg, Jr.
- Julia King & Raymond Cannetti
- Cecil W. & Nina Page
- Smigel Foundation
- Henry & Bernice Rowe
- Donald & Belinda Willis

**Landmark Society**

- Lynn & Bob Ripley
- Fred L. Brown
- Charitable Foundation